

# ALREFLEX WALL TIES

## MASONRY TO MASONRY WALL TIES

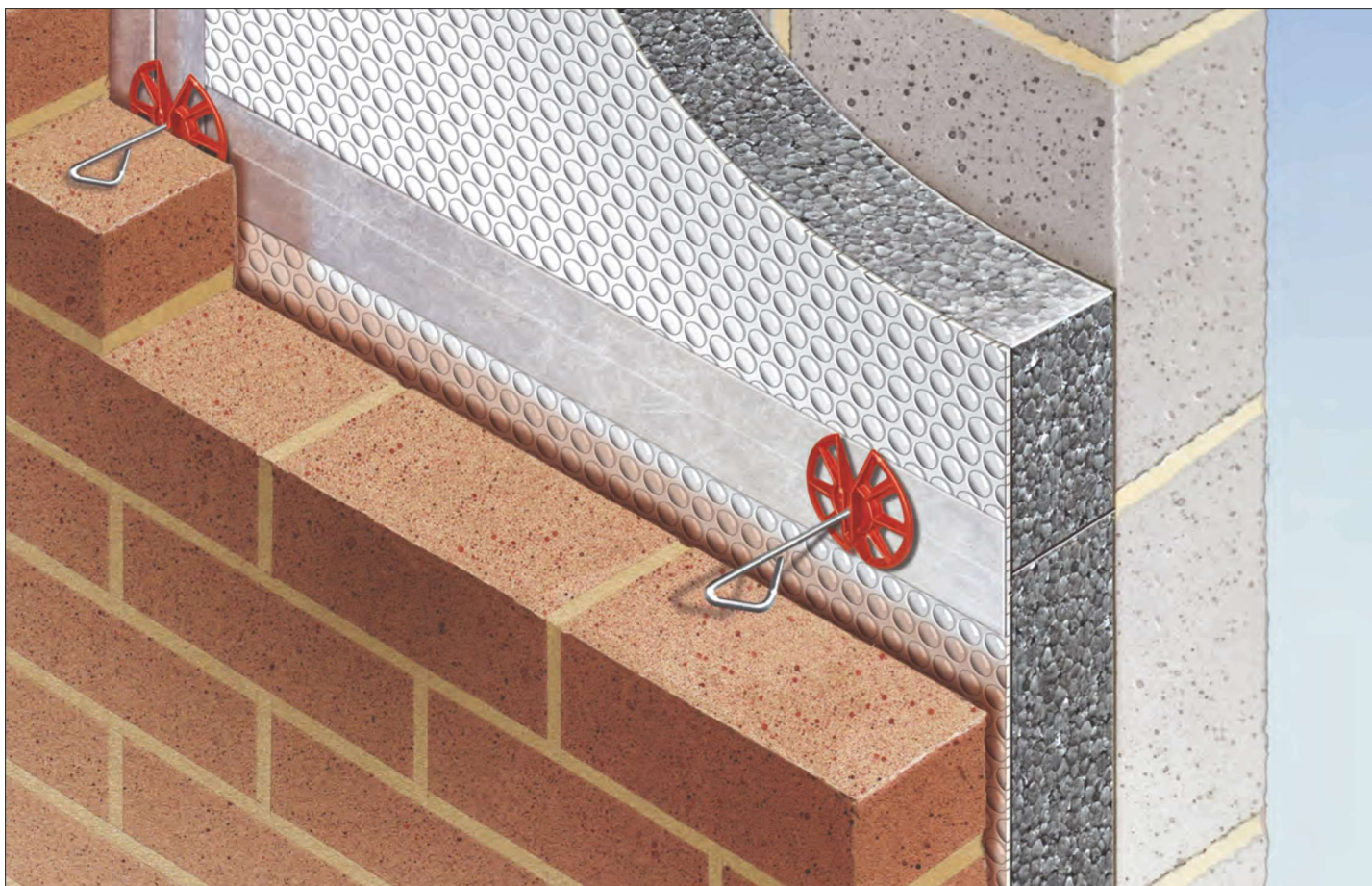

### Wall Ties for use with Cavity Board and Bubble Foil Insulations

- Built in Embedment Guide ensures correct positioning of ties.
- Quick and easy to install.
- UKCA Marked.
- Type A acoustic ties available.



## TE Cavity Board Wall Ties

Type 2 and Type 4 ties are suitable for use with **Thermal Economics** cavity insulation boards in masonry wall constructions including:

**ALREFLEX®  
PLATINUM®**  
Platinum is a registered trade mark of Springdale CPB Ltd

**ALREFLEX®  
FULL FILL**

**ALREFLEX®  
ULTRATHERM**

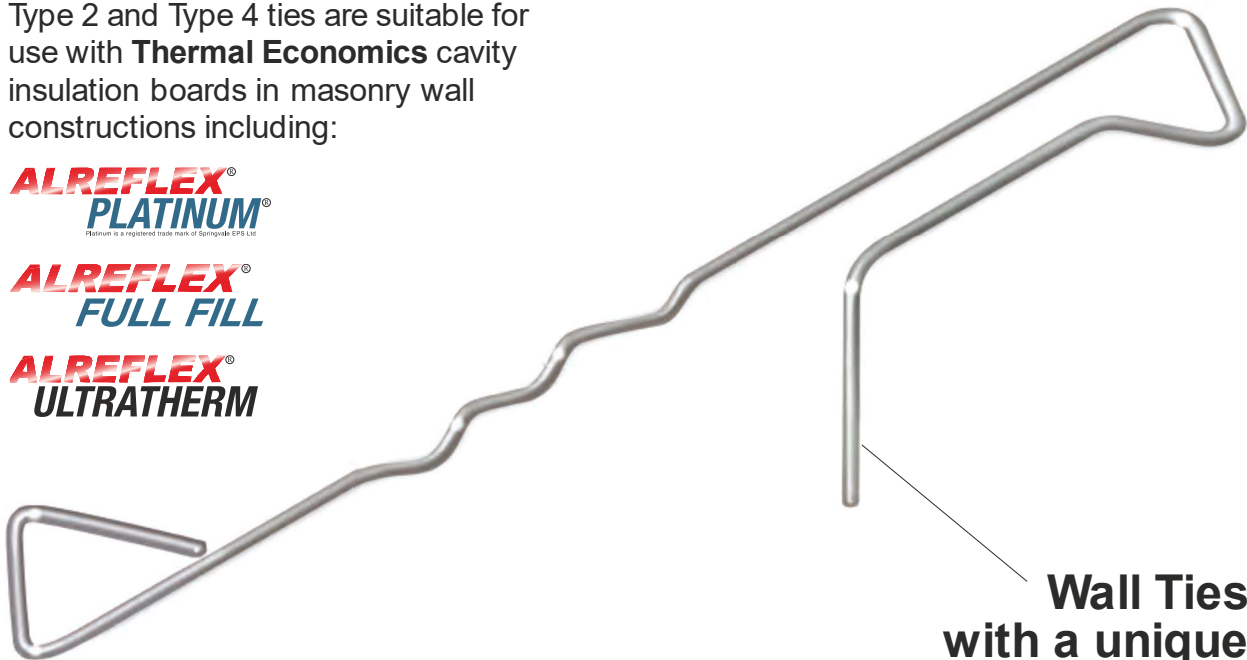

### Wall Ties with a unique embedment guide

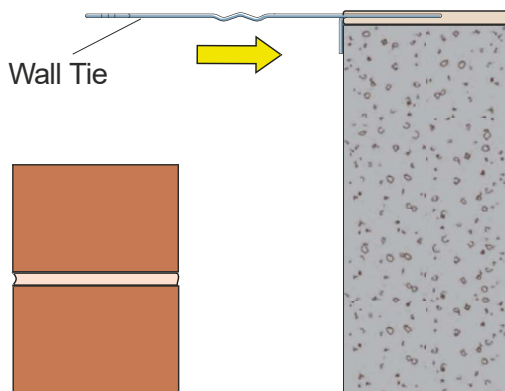

The proper embedment of wall ties is of vital importance, failure to do so compromises the performance of the ties and could lead to the collapse of masonry.

**Thermal Economics** cavity board wall ties have a built-in locating down stand which makes fitting them quick and simple.

The down stand is positioned against the Block work ensuring that the tie is embedded sufficiently and that the wall tie drips are positioned correctly.

### Wall Tie Selection Table

Maximum Building Height	Application	Cavity Range	Tie Length	PD 6697 Type	Product Code
10m	Light duty wall tie suitable for box form domestic dwellings with leaves of similar thickness	45 -60mm	185mm	4	WT4-CB-185
		60 -75mm	200mm	4	WT4-CB-200
		85 -100mm	225mm	4	WT4-CB-225
		110 -125mm	250mm	4	WT4-CB-250
15m	General purpose tie suitable for domestic and small commercial buildings	45 -60mm	185mm	2	WT2-CB-185
		60 -75mm	200mm	2	WT2-CB-200
		85 -100mm	225mm	2	WT2-CB-225

### Avoiding Installation Problems

The above table is for guidance only. As with all types of wall tie there will be situations where parameters other than those listed above

dictate the type of tie used. **It is the responsibility of the specifier to select the correct wall tie for each particular project.**

## Alreflex 2L2 Wall Ties

Type 2, 3 and 4 ties are suitable for use with **Thermal Economics** cavity bubble foil insulation in masonry wall constructions including:

**ALREFLEX®**  
**2L2FR**  
THERMAL INSULATION &  
RAINWATER BARRIER

**ALREFLEX®**  
**2L2**  
**Super-R CLASS 'O'**  
THERMAL INSULATION &  
VAPOUR & RAIN BARRIER

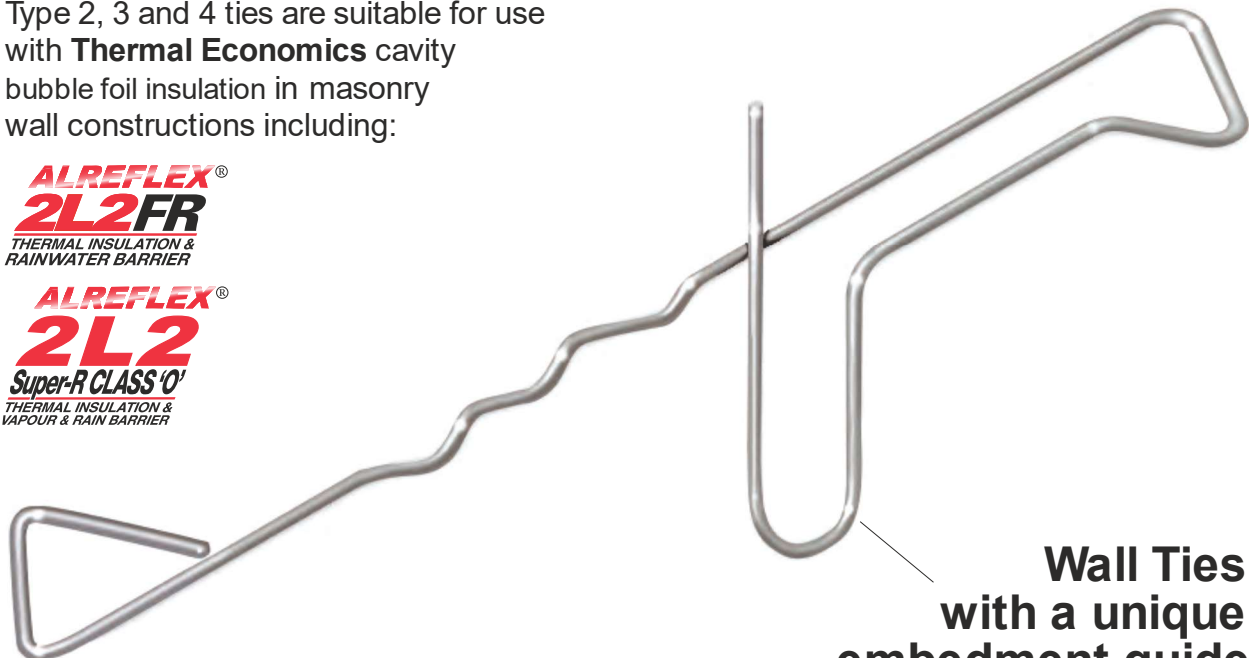

### Wall Ties with a unique embedding guide

The proper embedment of wall ties is of vital importance, failure to do so compromises the performance of the ties and could lead to the collapse of masonry.

Thermal Economics Alreflex 2L2 wall ties have a built in locating loop which makes fitting them quick and simple and ensures that the bubble foil insulation is spaced 25mm away from the block work. The loop is positioned against the block work ensuring that the tie is embedded sufficiently and that the wall tie drips are positioned correctly.

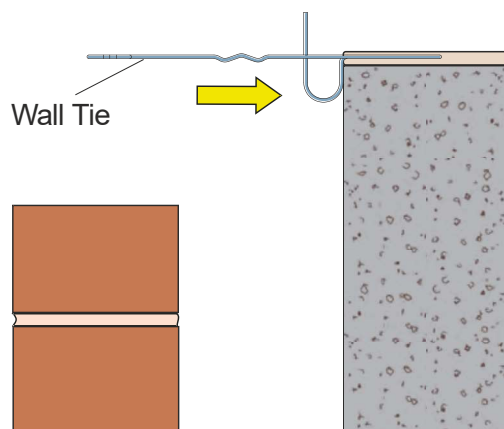

### Wall Tie Selection Table

Maximum Building Height	Application	Cavity Range	Tie Length	PD 6697 Type	Product Code
10m	Light duty wall tie suitable for box form domestic dwellings with leaves of similar thickness	60 -75mm	200mm	4	WT4-AF-200
		85 -100mm	225mm	4	WT4-AF-225
15m	General purpose tie suitable for domestic and small commercial buildings	45 -60mm	185mm	2	WT2-AF-185
		60 -75mm	200mm	2	WT2-AF-200
		85 -100mm	225mm	2	WT2-AF-225
		110-125mm	250mm	3	WT3-AF-250

### Avoiding Installation Problems

The above table is for guidance only. As with all types of wall tie there will be situations where parameters other than those listed above

dictate the type of tie used. **It is the responsibility of the specifier to select the correct wall tie for each particular project.**

## Retaining Discs

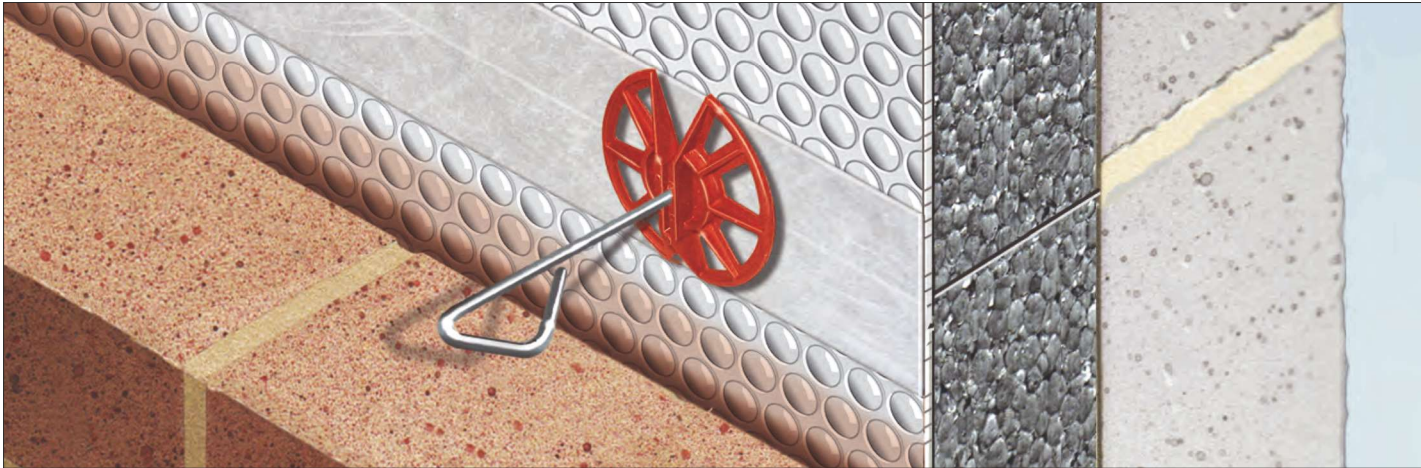

Retaining discs should be used to securely hold cavity insulation in place. The **AB Retaining Disc** is designed for use with **Thermal Economics Wall Ties**.

They are suitable for use with cavity boards and bubble foil insulations.

**AB Retaining disc**  
for use with Thermal  
Economics wall ties.

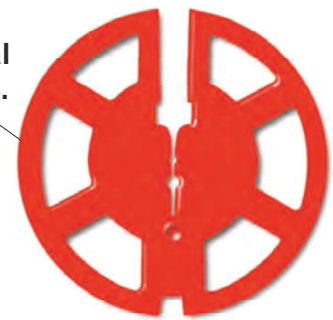

### Part E - Sound Insulation

WT4 ties are classified as Type A and are suitable for separating (party) and external walls.

WT2 ties are classified as Type B and are only suitable for external walls.

### Wall Tie Density

Please refer to product specific BBA Certificates and NHBC guidance for Information regarding wall tie centres.

Thermal Economics is an insulation leader in thermal and acoustic solutions for the UK construction market. As specialists in this field with over 35 years of success,

we continually invest in R&D to provide innovative and high-performance solutions that remain cost effective as well as meet and exceed building regulation requirements.



T: 01582 450814  
E: [info@thermal-economics.co.uk](mailto:info@thermal-economics.co.uk)  
W: [www.thermal-economics.co.uk](http://www.thermal-economics.co.uk)



Visit our website  
for mobile friendly  
installation guides



For help choosing the right product for your project please contact Thermal Economics  
Technical Department on 01582 544255  
For all our Acoustic & Thermal insulation products visit: [www.thermal-economics.co.uk](http://www.thermal-economics.co.uk)