

## BBA certified thermal insulation and floor systems

**TE Platinum Ground Floor** Insulation is used by major UK House builders with over 3 million sq. metres being successfully installed.

Made from EPS, it does not absorb water from the ground. It's also environmentally friendly: No CFC's or HCFC's are used in it's production.

- Insitu Concrete Floors
- Beam & Block Floors
- Beam & Insulated Block Floors
- Timber Floors
- Floating Floors / Existing Floors
- Edge Insulation

 **Approved Document  
Part L 2021 Solutions**

 **Technical Handbook  
Section 6 2023 Solutions**

 **Approved Document  
Part L 2022 Solutions**

## Low cost solution

**TE Platinum Ground Floor** Insulation is an extremely cost effective alternative to PUR & PIR insulation boards with equivalent thermal performance. Just call us to discuss your next project and how we might save you money.

British made-  
readily available

Available to buy now, and  
made right here in Britain.



For help choosing the right product for your project, please call the Thermal Economics Technical Department on 01582 544255.

A cost effective solution for Part L 2021 & Section 6 2023 compliance

**TE Platinum Ground Floor Insulation** provides an extremely cost effective alternative to PUR & PIR insulation boards with equivalent thermal performance.

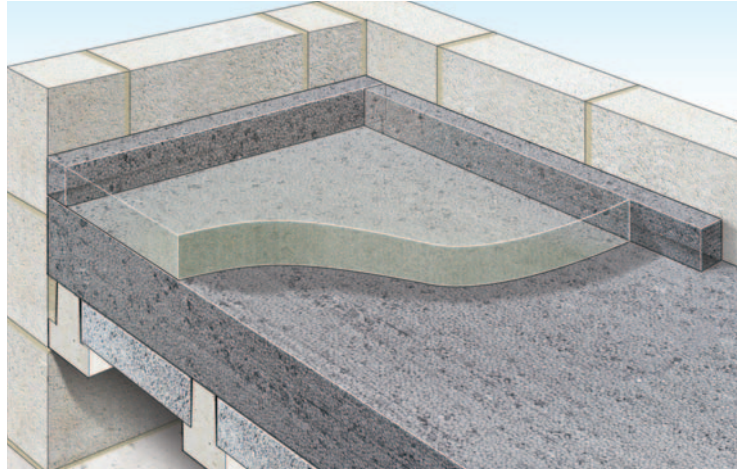

### U-Value Examples- Concrete Slab

		Perimeter / Area Ratio								
		0.1	0.2	0.3	0.4	0.5	0.6	0.7	0.8	0.9
Insulation Thickness (mm)	150	0.09	0.12	0.13	0.14	0.15	0.15	0.16	0.16	0.16
	225	0.07	0.09	0.10	0.11	0.11	0.11	0.11	0.11	0.12

### U-Value Examples- Beam & Block

		Perimeter / Area Ratio								
		0.1	0.2	0.3	0.4	0.5	0.6	0.7	0.8	0.9
Insulation Thickness (mm)	150	0.10	0.12	0.13	0.14	0.14	0.14	0.15	0.15	0.15
	225	0.08	0.09	0.10	0.10	0.10	0.11	0.11	0.11	0.11

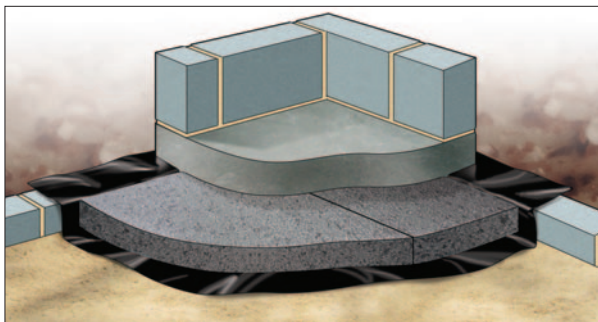
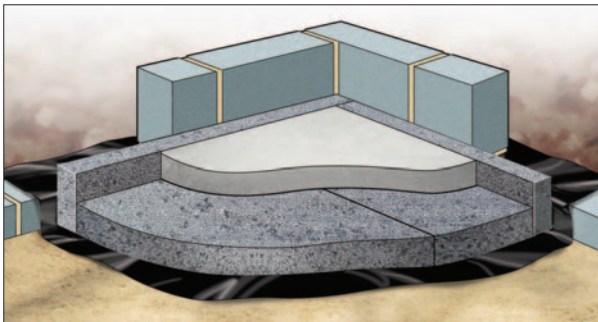

Building Regulations require new build floors to achieve the following area weighted averages:

- Approved Doc. Part L 2021 (England) - 0.18W/m<sup>2</sup>K
- Technical Handbook Section 6 2023 (Scotland) - 0.15W/m<sup>2</sup>K
- Approved Doc. Part L 2022 (Wales) - 0.15W/m<sup>2</sup>K

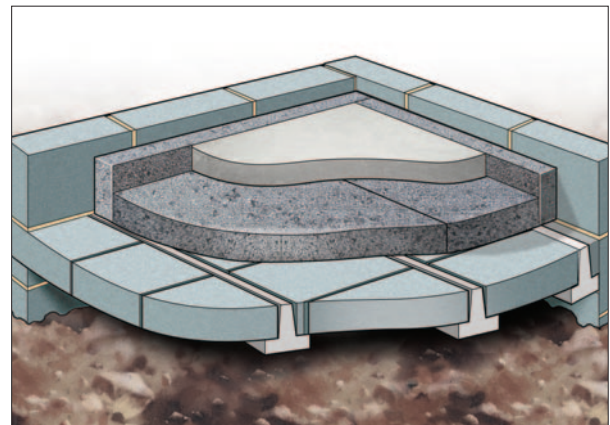

T: 01582 450814  
 E: info@thermal-economics.co.uk  
 W: www.thermal-economics.co.uk



Visit our website for mobile friendly installation guides



For help choosing the right product for your project please contact Thermal Economics Technical Department on 01582 544255

For all our Acoustic & Thermal insulation products visit: [www.thermal-economics.co.uk](http://www.thermal-economics.co.uk)