

IsosonicTM Topfloor

FIXED RESILIENT SURFACE LAYER
SOUND INSULATION FOR CONCRETE FLOORS



**including proprietary screeds*

SITE TESTED FOR APPROVED DOCUMENT PART E REQUIREMENTS

- ▶ Ideal solution for BREEAM projects, site test results consistently exceed building regulation requirements
- ▶ Suitable for solid in-situ, precast plank, steel composite and beam and block floor constructions
- ▶ Widely used in framed construction
- ▶ **Isorubber Top** is a tough material suitable for the direct application of most types of floor covering. It is CERAM tested for use beneath ceramic tiles and SATRA tested for use beneath vinyl coverings
- ▶ Attractive (selling) surface
- ▶ Tested for foot traffic durability by the British Carpet Technical Centre



Isorubber Top is a composite of sustainably sourced granulated cork and recycled waste rubber. It has a Global Warming Potential of Zero and an Ozone Depletion Potential of Zero providing a means of using problematic waste material to the benefit of the environment.

**Thermal
Economics**
THERMAL & SOUND INSULATION TECHNOLOGY

Please visit our website for the full range of Thermal and Sound Insulation products at
www.thermal-economics.co.uk

PERFORMANCE DATA

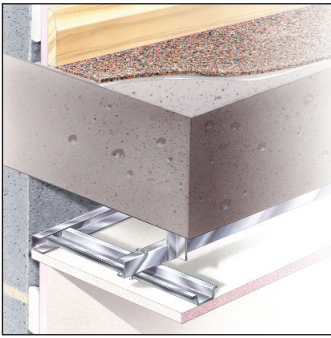

Construction 1:	IsoRubber Top laid on 180mm insitu concrete slab. Typical MF ceiling construction with 100mm void. Standard 12.5mm plasterboard	
	Airborne Insulation (DnTw+Ctr)	Impact (Lntw)
Average Site Test Results:	55dB (10dB better than regs)	50dB (12dB better than regs)
Regulations Requirements	45dB or greater	62dB or lower

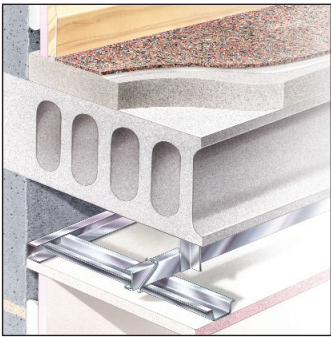

Construction 2:	IsoRubber Top laid on screeded 150mm precast concrete plank. Typical MF ceiling construction with 150mm void. Standard 12.5mm plasterboard	
	Airborne Insulation (DnTw+Ctr)	Impact (Lntw)
Average Site Test Results:	52dB (7dB better than regs)	50dB (12dB better than regs)
Regulations Requirements	45dB or greater	62dB or lower

THE PRODUCT

IsoRubber Top is a blend of reconstituted rubber and cork formed with a polyurethane binder.

The granules are sourced from very high grade manufacturing waste (medical and food production), while the cork is from managed European sources.

Because of this unique mix, the product can accommodate direct application of most typical decorative overlays, including carpet, laminate or timber, vinyl sheet and ceramic tiles.

IsoRubber Top is produced in a standard 3mm thickness, but other thickness' and roll sizes can be made to order.



- * Versatile
- * Easy to use
- * Effective
- * Durable
- * Sustainable

TECHNICAL BENEFITS

This mix of organically produced materials offers a number of technical benefits over many of its petrochemical derivative rivals:

- a) High KINETIC ENERGY (sound vibration) absorption combined with negligible short and long term compressibility;
- b) Compatibility with the most commonly used floor finishing materials;
- c) Resistance to temporary foot traffic exposure;
- d) Attractive appearance for "Sales" finishing purposes.

ENVIRONMENTAL BENEFITS

Both rubber and cork are natural "tree harvest" materials which are not only sustainable but increase the need for tree plantation and management.

Rubber, however, biodegrades slowly and therefore the use of recycled industrial waste into a new long term application provides, in itself, a considerable environmental benefit.

IsoRubber products are also used in Thermal Economic's Isosonic Systems for screeded overlay solutions for precast concrete and timber floors between apartments to Approved Document 'E' 2003.

Contact our Technical Department for details.

Technical Department

Tel: 01582 544255

Sales Office

Tel: 01582 544256

FASTRACKCAD
ARCHITECTURAL CAD DATABASES



Thermal Economics
THERMAL & SOUND INSULATION TECHNOLOGY